







dhala kuppaswamy rebello
ARCHITECTS PLANNERS
INTERIOR DESIGNERS
59, ormes road, kilpauk, madras-10

PROJECT proposed
HOME FOR THE BLIND
IN S.No 229/2A2& 2B4 AT VILLAGE No 120 medavakkam village saidapet taluk CHENGAI M.G.R DISTRICT

LEGEND
PROPOSED ———  ROAD ——— 
PLOT BOUNDARY ———  SEWER LINE ——— 

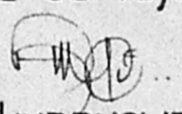
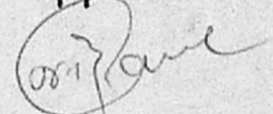
licensed surveyor RA NO 245 
suresh kuppaswamy
Arch., M.T.P., F.IIA, A.I.T.P., REGISTERED ARCHITECT CA/77/4228
applicant 
Dist 324-A-
Wing foundation for the blind

TITLE
AUTHORITIES APPROVAL DRAWINGS
site plan, foundation details . etc.

PROJECT NO	242/92	
SCALE	AS SHOWN	REVISIONS
DATE	19-12-92	SHEET NO
DRAWN	s.p	5
CHECKED		

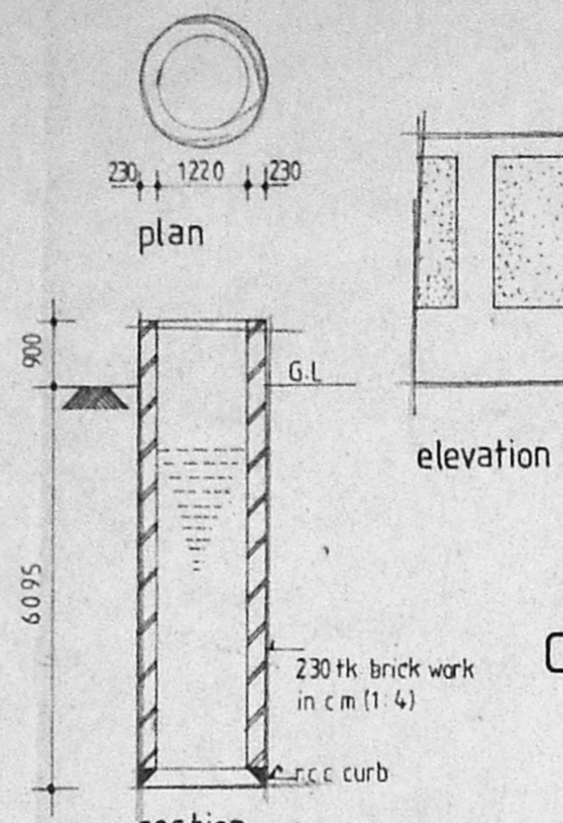
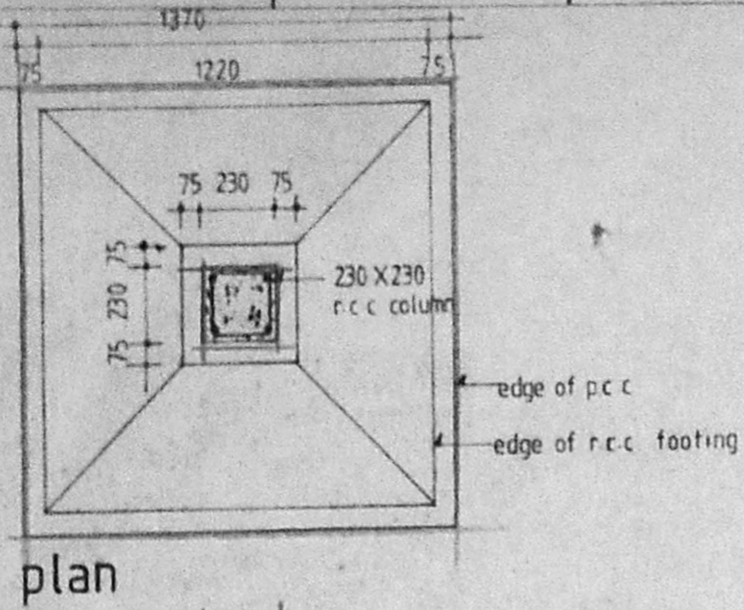

COMPOUND WALL AND WELL DETAIL

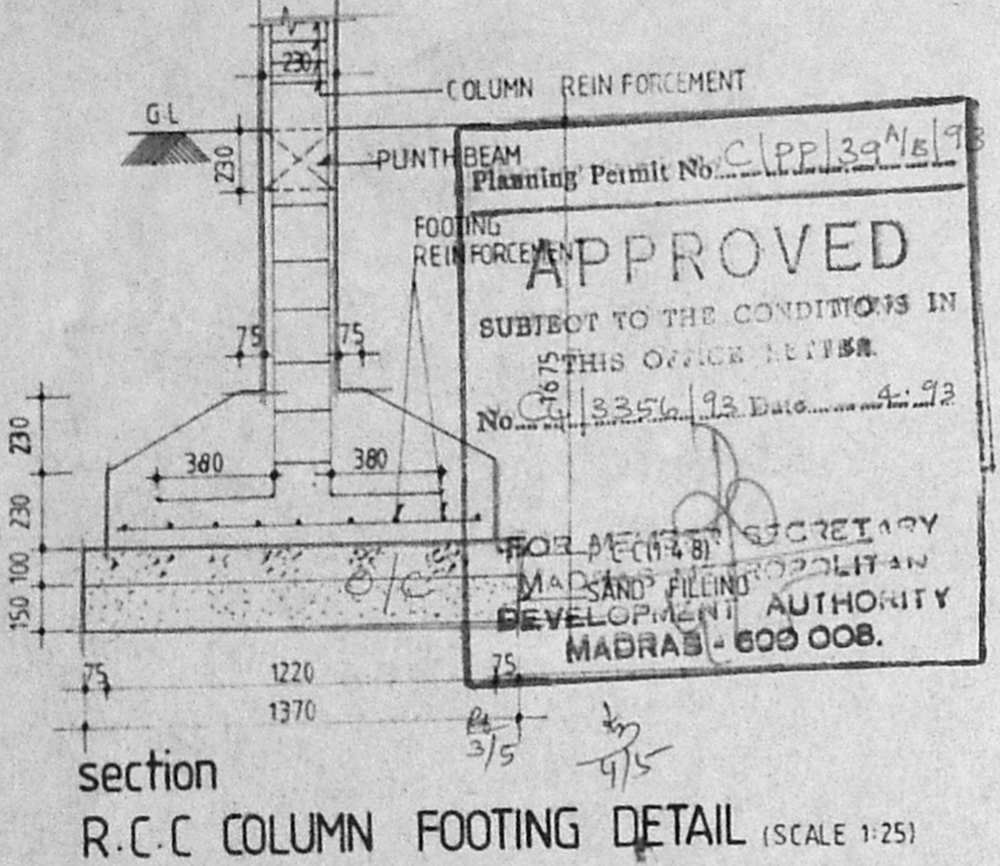

section (SCALE 1:100)
MMDA C / PP NO /
C.No. C4/3256/93
Asst.
Scrutiny: 10/3 1/2
PART I 8/13/93
PART II
km
19/13

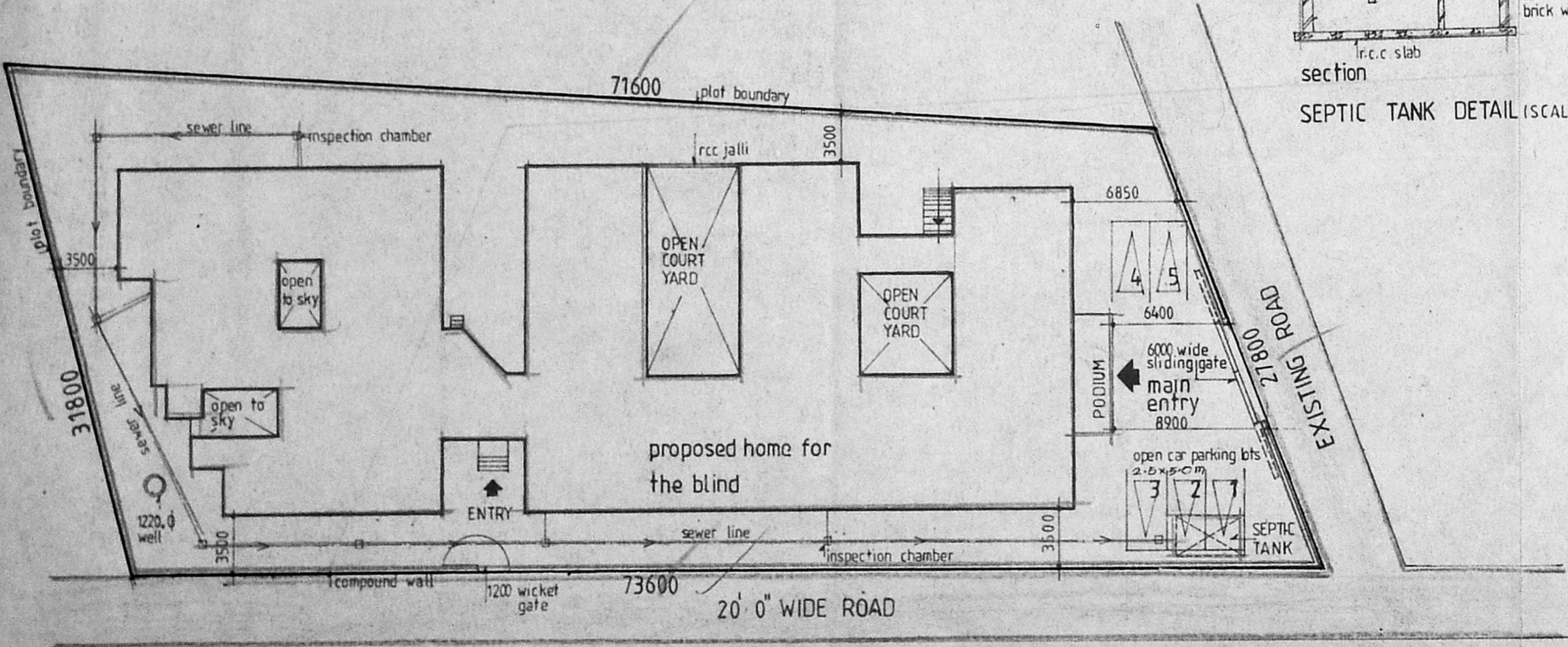
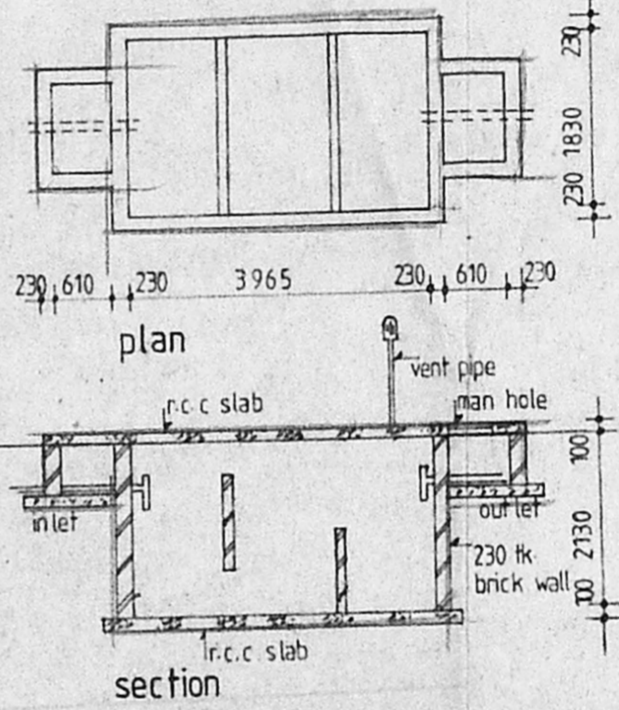

SITE PLAN (SCALE = 1:300)

